

Additional operating manual

PROFIBUS fieldbus

Type: FKO PROFIBUS

Status: 24/07/2015

Original Additional operating instructions

V1.7 DE

Only valid with operating manual for the FKO

Document number: DOC01.7_784xyz-0009

Legal notice

BRINKMANN PUMPEN
K. H. Brinkmann GmbH & Co. KG
Friedrichstraße 2
58791 Werdohl
Germany
Tel. +49 (0)2392 5006-0
Fax +49 (0)2392 5006-180
sales@brinkmannpumps.de

Exclusion of liability

All names, trademarks, product names or other designations given in this manual may be legally protected even if this is not labelled as such (e.g. as a trademark). BRINKMANN assumes no liability for their free usage.

The illustrations and texts have been compiled with great care. However, the possibility of errors cannot be ruled out. The compilation is made without any guarantee.

General note on gender equality

BRINKMANN is aware of how language impacts on gender equality and always makes an effort to reflect this in documentation. Nevertheless, for the sake of readability we are unable to use non-gender-specific terms throughout and use the masculine form instead.

© 2015 K.H. BRINKMANN GmbH & Co. KG

All rights reserved by BRINKMANN, including those of reproduction by photocopy and storage in electronic media. Commercial use or distribution of the texts, displayed models, diagrams and photographs appearing in this product is not permitted.

This manual may not be reproduced, stored, transmitted or translated in any form or by means of any medium - in whole or in part - without prior written permission.

Contents

1.	General information	5
1.1	Information about documentation	5
1.1.1	Other applicable documents	6
1.1.2	Storing the documentation	6
1.2	Notes in this manual	7
1.2.1	Warnings	7
1.2.2	Warning symbols used	8
1.2.3	Signal words	8
1.2.4	Information notes	9
1.3	Symbols used in this manual	10
1.4	Qualified staff	11
1.5	Proper use	11
1.6	Responsibility	12
1.7	Safety instructions	13
1.7.1	General information	14
2.	Device and system description	15
2.1	PROFIBUS	15
2.1.1	Master / slave operation	16
2.2	Scope of delivery	16
2.3	Hardware components	17
2.3.1	Interfaces on the drive controller	18
2.3.2	Pin assignment for interfaces	21
2.3.3	Cable	21
2.4	Software components	21
3.	Installation	22
3.1	Configuration of the drive controller for PROFIBUS	23
3.2	FKO bus address	23
3.2.1	Setting the address on the communication card	26
3.3	Setting the field bus address via rotary switches Switch 1/Switch 2	27
3.4	Installing the FKO GSD file	29
4.	Accessing data via PROFIBUS	30
4.1	Cyclic data access - Process data Out	30
4.1.1	Structure of Process data Out	30
4.1.2	Structure of FKO status word	33
4.1.3	Process data Out which can be parameterised	34
4.2	Cyclic data access - Process data In	36
4.2.1	Structure of FKO control word	38
4.2.2	Process data In which can be parameterised	40
4.3	Non-cyclic data access / parameters	40
4.3.1	Non-cyclic data	41

Contents

4.3.2 Direct access41

4.3.3 Indirect access42

4.3.4 Parameter43

5. Error detection and troubleshooting.....52

5.1 Error word of application side52

5.2 Error word of power side53

6. EC declaration of conformity54

1. General information

Thank you for choosing an FKO drive controller with PROFIBUS from BRINKMANN! Our FKO line of drive controllers is designed to be universally usable with all common motor types and bus systems.

If you have any technical questions, please call our central service hotline:

Tel.: +49 (0)2392 5006-0

Fax: +49 (0)2392 5006-180

sales@brinkmannpumps.de

1.1 Information about documentation

This documentation is a supplementary operating manual for the FKO drive controller with the PROFIBUS bus system. It contains all the important information you need to install and operate the bus system.

Please read the operating manuals for the drive controller and bus system through carefully. They contain important information for operating the FKO with fieldbus.

We assume no liability for any damage resulting from non-observance of this manual.

This manual is an integral part of the product and applies exclusively to the FKO with PROFIBUS from K.H. Brinkmann GmbH & Co. KG.

Provide the operator of the system with this manual so it is available when needed.

General information

1.1.1 Other applicable documents

This refers to all manuals that describe how to operate the drive controller system and any other manuals for the equipment used.

1.1.2 Storing the documentation

Store this operating manual and all other applicable documents carefully so they are available when needed.

1.2 Notes in this manual

1.2.1 Warnings

The warnings refer to life-threatening dangers. Serious injuries possibly resulting in death may occur.

Each warning consists of the following elements:

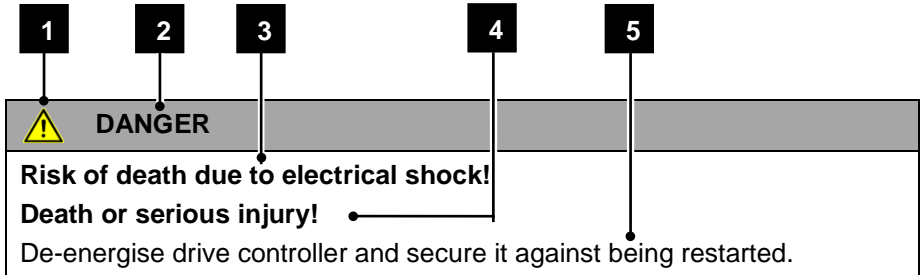

Fig.: 1 Structure of warnings

- 1 Warning symbol
- 2 Signal word
- 3 Type of danger and its source
- 4 Possible consequence(s) of failure to comply
- 5 Corrective actions

1.2.2 Warning symbols used



Danger



Danger due to electrical shock and discharge



Danger due to burns



Danger due to electromagnetic fields

1.2.3 Signal words

Signal words are used to identify the severity of the danger.

DANGER

Indicates a direct hazard with a high level of risk, which, if not avoided, will result in death or serious injury.

WARNING

Indicates a hazard with a moderate level of risk, which, if not avoided, will result in death or serious injury.

CAUTION

Indicates a hazard with a low level of risk, which, if not avoided, may result in minor or slight injury or property damage.

1.2.4 Information notes

Information notes contain important instructions for the installation and problem-free operation of the drive controller. These must be followed at all times. The information notes also point out that failure to observe can result in damage to property or financial damages.



IMPORTANT INFORMATION

The drive controller may only be assembled, operated, maintained and installed by trained and qualified staff.

Fig.: 2 Example of an information note

Symbols within the information notes



Important information



Damage to property possible

Other notes



INFORMATION



Enlarged view

1.3 Symbols used in this manual

Symbol	Meaning
1., 1., 3. ...	Consecutive steps in a handling instruction
➔	Effect of a handling instruction
✓	Final result of a handling instruction
■	List

Fig.: 3 Symbols and icons used

Abbreviations used

Abbreviation	Explanation
Tab.	Table
Fig.	Figure
It.	Item
Ch.	Chapter

1.4 Qualified staff

In the context of this operating manual, qualified staff refers to electronics specialists who are familiar with the installation, assembly, commissioning and operation of the drive controller and the dangers involved, and whose specialist training and knowledge of relevant standards and regulations provide them with the necessary abilities.

1.5 Proper use

If the device is installed in a machine, drive controllers may not be commissioned (i.e. intended operation may not begin) until it has been determined that the machine complies with the regulations of EC Directive 2006/42/EC (Machinery Directive); DIN EN 60204-1; VDE 0113-1:2007-06 must be observed.

Commissioning (i.e. beginning intended operation) is only permitted if the EMC Directive (2004/108/EC) is complied with.

The harmonised standards of DIN EN 50178; VDE 0160:1998-04 must be applied for this drive controller along with DIN EN 60439-1; VDE 0660-500:2005-01.

This drive controller may not be operated in areas where there is a danger of explosion!

Repairs may only be performed by authorised repair bodies. Independent and unauthorised intervention may result in death, injury or property damage. The warranty provided by BRINKMANN will be invalidated in such cases.

External mechanical loads such as stepping on the housing are not permitted!



IMPORTANT INFORMATION

Using drive controllers in equipment that is not fixed is considered as an exceptional environmental condition and is only permitted if allowed by the standards and guidelines applicable on site.

1.6 Responsibility

As a basic principle, electronic devices are not fail-safe. The operator and/or the contractor setting up the machine or system is responsible for ensuring that the drive switches to a safe state if the device fails.

The “Electrical equipment of machines” section in DIN EN 60204-1; VDE 0113-1:2007-06, “Safety of machinery” describes the safety requirements for electrical control units. These are provided for the safety of people and machines and must be observed in order to retain the functional capability of the machine or system.

An emergency stop feature does not have to result in the voltage supply to the drive being switched off. To avoid dangerous situations, it may be useful for individual drives to remain operational or for specific safety procedures to be initiated. The effectiveness of emergency stop measures is evaluated by means of a risk assessment for the machine or system and its electrical equipment, and is determined by selecting a circuit category according to DIN EN 13849 “Safety of machinery – Safety-related parts of control systems”.

1.7 Safety instructions

The following warnings, precautionary measures and information are provided for your safety and serve to prevent damage to the drive controller and the components connected to it. This chapter contains warnings and information that are generally applicable when handling drive controls. They are split into general information, transport & storage and dismantling & disposal.

Specific warnings and comments that apply to specific activities can be found at the start of the appropriate chapters and are repeated or added to at various critical points in these chapters.

Please read this information carefully as it is provided for your personal safety and will also prolong the life of the drive controller and connected devices.

1.7.1 General information



IMPORTANT INFORMATION

Carefully read this operating manual and the warning signs affixed to the drive controller before installation and commissioning. Make sure that all warning signs on the drive controller are legible; replace any missing or damaged signs.

They contain important information on the installation and operation of the drive controller. In particular, note the information in the "Important information" chapter. K.H. Brinkmann GmbH & Co. KG assumes no liability for damages arising from the non-observance of this operating manual.

This operating manual is an integral part of the product. It applies exclusively to the drive controller from K.H. Brinkmann GmbH & Co. KG.

Keep the operating manual close to the drive controller so it is easily accessible to all users.



IMPORTANT INFORMATION

The drive controller can only be operated safely if the required environmental conditions listed in the "Suitable environmental conditions" chapter of the operating manual are met.



DANGER

Risk of death due to electrical shock!

Death or serious injury!

De-energise drive controller and secure it against being restarted.

2. Device and system description

This chapter contains information on the scope of delivery for the drive controller and the function description.

2.1 PROFIBUS

With the help of the PROFIBUS, devices from various providers can communicate without special adaptation. PROFIBUS differentiates between master and slave devices independently, so that multi-master operation is also possible.

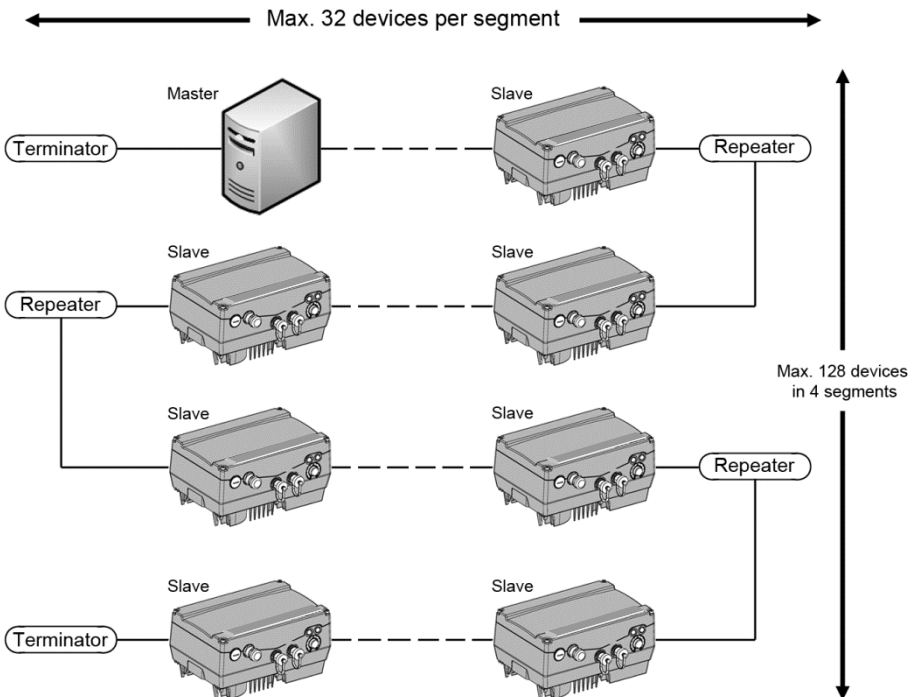

Fig.: 4 Wiring and bus connection



A repeater must be used when more than 32 devices (e.g. FKO) are operated on one PROFIBUS string.

Data transfer rates

The data transfer rate can be set in the master within a range from 9.6 kbit/s to 12 Mbit/s. The data transfer is selected when setting up the field bus and applies to all participants.

The maximum length of a segment stands in a reversely proportional relationship to the data transfer rate (see table).



IMPORTANT INFORMATION

The FKO adapts automatically to the baud rate.

Data transfer rate (kbit/s)	9.6	19.2	93.75	187.5	500	1500	3000	6000	12000
Length/segment (m)	1200	1200	1200	1000	400	200	100	100	100

2.1.1 Master / slave operation

The FKO should only be operated as a PROFIBUS slave.

2.2 Scope of delivery

The scope of delivery is described in the FKO basic documentation.

The interface card is part of the FKO.

2.3 Hardware components

Hardware components for connecting the FKO to a PROFIBUS bus system:



The FKO is fitted in the factory with the appropriate communication card.

The FKO cannot be retrofitted or converted at a later date.

2.3.1 Interfaces on the drive controller

The following connections can be found on the FKO with PROFIBUS interface card.

Size A:

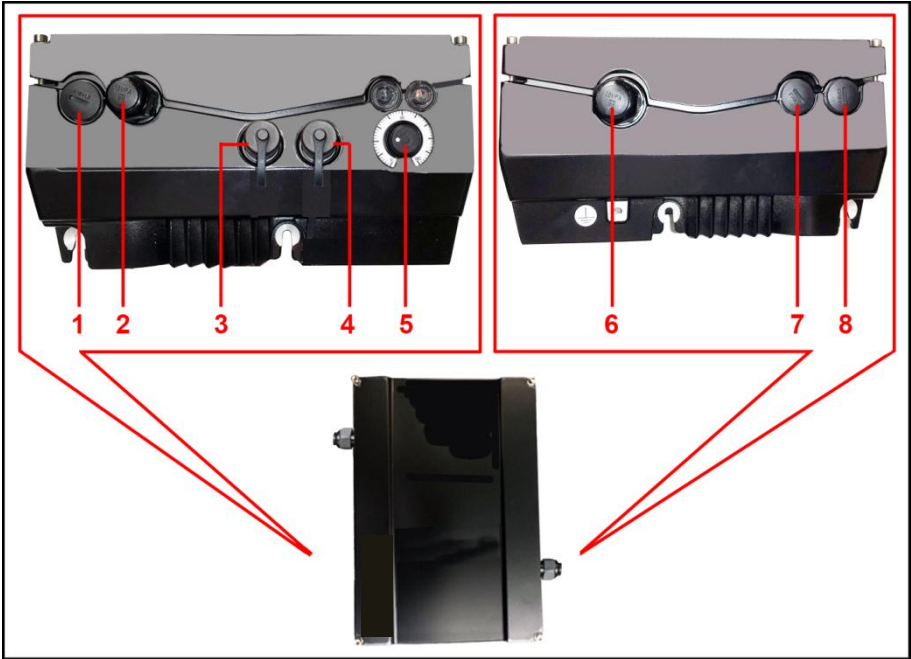

Fig.: 5 BG connections. A "PROFIBUS"

BG connections. A "PROFIBUS"		
1	Blind plug	
2	Control line	
3	PROFIBUS	
4	MMI	
5	Potentiometer	
6	Grid connection	
7	Blind plug	STO (mount the EMC threaded connection in the accessory pack)
8	Blind plug	STO (mount the EMC threaded connection in the accessory pack)

Sizes B - C

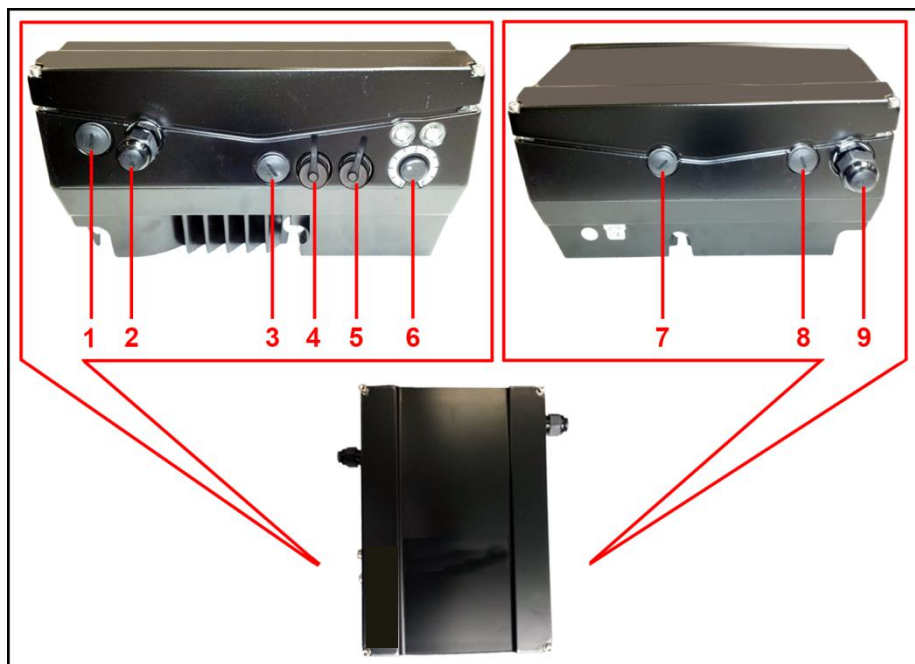

Fig.: 6 BG connections. B - C "PROFIBUS"

BG connections. B - C "PROFIBUS"	
1	Blind plug STO (mount the EMC threaded connection in the accessory pack)
2	Control line
3	Blind plug
4	PROFIBUS
5	MMI
6	Potentiometer
7	Blind plug STO (mount the EMC threaded connection in the accessory pack)
8	Blind plug STO (mount the EMC threaded connection in the accessory pack)
9	Grid connection

Size D:

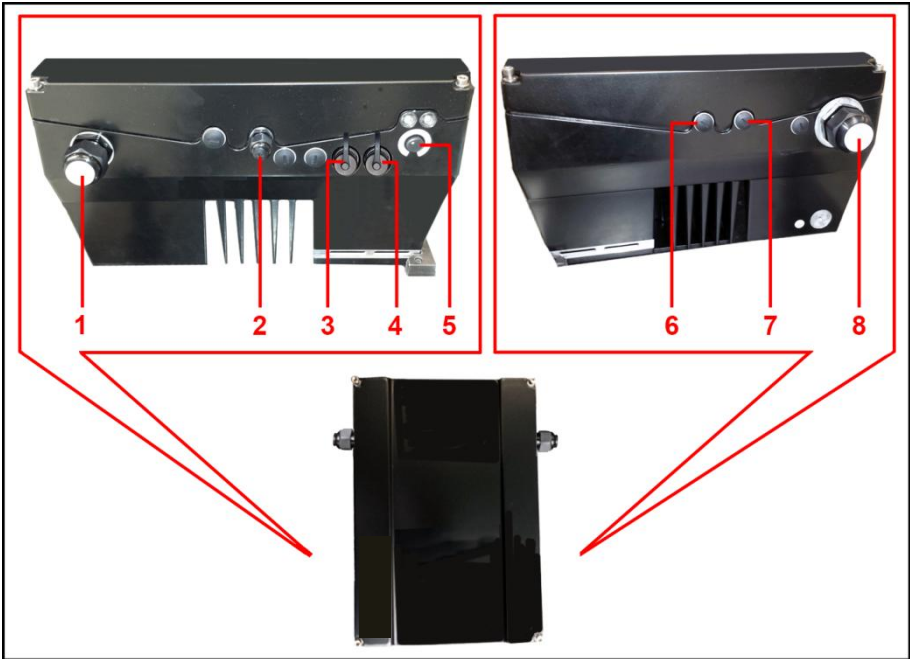

Fig.: 7 BG connections. D "PROFIBUS"

BG connections. D "PROFIBUS"	
1	Cable screw connection with blind plug
2	Control line
3	PROFIBUS
4	MMI
5	Potentiometer
6	Blind plug STO (mount the EMC threaded connection in the accessory pack)
7	Blind plug STO (mount the EMC threaded connection in the accessory pack)
8	Grid connection

2.3.2 Pin assignment for interfaces

Pin assignment on device side of M12 socket for PROFIBUS:

	PIN no.	Signal
	1	+ 5 V DC
	2	RxD/TxD-N / A-line (green)
	3	Ground
	4	RxD/TxD-P / B-line (red)
	5	Not used
	Housing	Shielding

Fig. 8: Round plug connector, 5-pin, M12, B-coded for PROFIBUS fieldbus

2.3.3 Cable

The following points should be observed when wiring:

- Lay bus and power cables as far apart as possible (min. 30 cm),
- If cables do cross, an angle of 90° should be observed if possible.

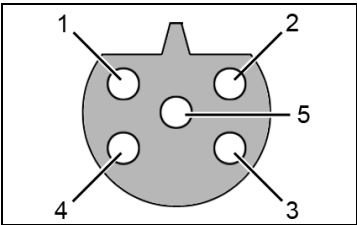
2.4 Software components

What software do I require to operate and configure the drive controller with PROFIBUS.

The FKO drive controller can be parameterised using the FKOpC tool and MMI (see operating manual) as well as the PROFIBUS master.

3. Installation

The fieldbus line is exclusively connected via an M12 Y-distributor found on the front of the M12 connection socket.

The PROFIBUS M12 Y distributor must demonstrate the following features:

- 2× plugs 5-pin
- 1× socket 5-pin
- Completely shielded
B code

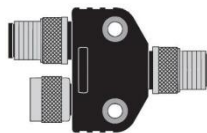

M12 Y distributor
Terminating resistor

A terminating resistor must be installed at both ends of the PROFIBUS.

The terminating resistor must demonstrate the following features:

- Plug 5-pin
B code

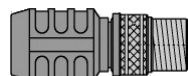

Terminating resistor

3.1 Configuration of the drive controller for PROFIBUS

In order that the drive controller can be controlled by the fieldbus, the following basic parameters must be set using the FKOpC tool, MMI or PROFIBUS master:

- Set parameter 1.130 (target value source) to fieldbus "9"
- Set parameter 1.131 (target value approval) to fieldbus "6"

3.2 FKO bus address



DANGER

Risk of death due to electrical shock!

Death or serious injury!

De-energise drive controller and secure it against being restarted.

In order that an FKO, equipped with a PROFIBUS communication card, can be clearly recognised in a PROFIBUS system, it must be assigned an address. The assignment can take place:

- By setting the address via the rotary switches "Switch 1" and "Switch 2" found on the printed circuit board (PCB).
- By setting the parameter 6.060 "Fieldbus address" (see chapter "Parameter list" of the operating manual)
Use FKOpC, MMI or PROFIBUS master for parameterisation.

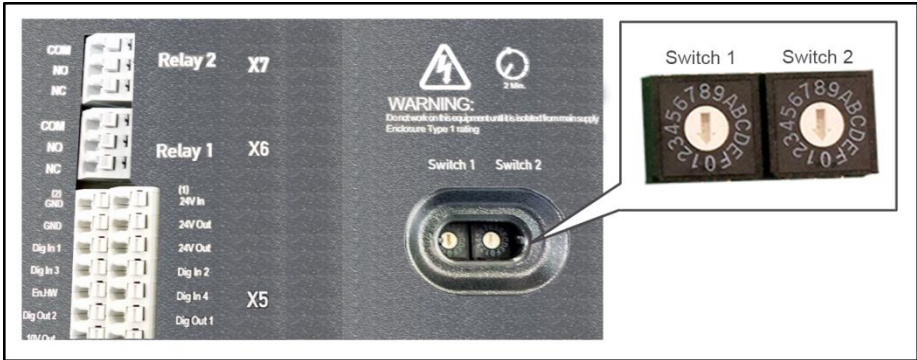

Fig.: 9 Setting parameters via rotary switches"

Switch 1 – for the unit position

Switch 2 – for the tens position

General instructions for addressing

- The addresses "0" are reserved in the General Diagnostic Tools, for example, programming devices.
- The address "126" is conceived of as a delivery address (default value) for bus participants in all rules; its address can be set via the field bus (SSA service).
- The address "127" is reserved for addressing all bus participants or groups (broadcast) and may thus not be set on an FKO.
- The addresses of the master stations should start with the lowest addresses. This means that a single master has the address "1" and additional masters then have the address "2", "3", etc.
A maximum of 124 free slave stations thus remain in a PROFIBUS network with one master.
- Repeater, coupler and FOC converter transmit their telegrams transparently from segment to segment. They don't require their own address for this reason.

Installation

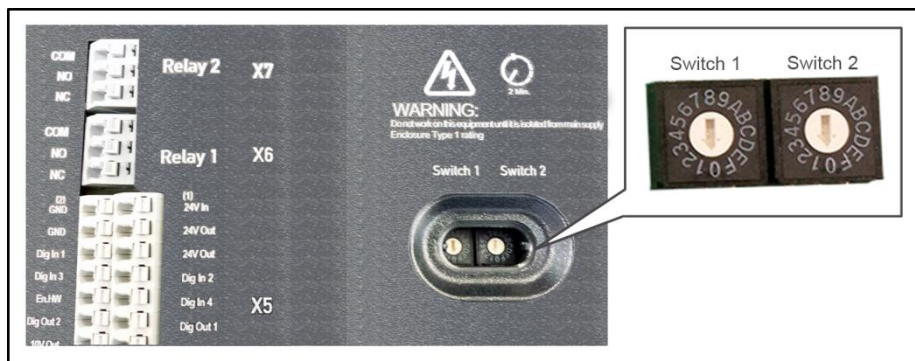

Both rotary switches (Switch 1/Switch 2) are set to the value "0" in the delivery state. Only in this state can addressing via the parameter 6.060 "Field bus address" take place.

The default address 125 is active when the rotary switches (Switch 1/Switch 2) and the parameter are set to address "0".



IMPORTANT INFORMATION

The address change only takes effect after "Power On".

3.2.1 Setting the address on the communication card



DANGER

Risk of death due to electrical shock!

Death or serious injury!

De-energise drive controller and secure it against being restarted.



IMPORTANT INFORMATION

The address of an FKO must lie within the range from 2 to 125.



Procedure

1. Switch the drive controller to voltage-free.
2. Unscrew the cover of the drive controller.
3. Set the address with a screwdriver on both switches (Switch 1/Switch 2).



IMPORTANT INFORMATION

You can find the corresponding address for the switch positions in chapter 3.3 "[Setting the field bus address via rotary switches Switch 1/Switch 2](#)".

4. Screw the cover of the drive controller back onto the housing (torque 4 Nm).
 5. Switch the voltage supply for the drive controller on.
- ✓ The address of the FKO is set.

3.3 Setting the field bus address via rotary switches

Switch 1/Switch 2

Address		Settings	
DECIMAL	HEX	Switch 2	Switch 1
0	0	0	0
1	1	0	1
2	2	0	2
3	3	0	3
4	4	0	4
5	5	0	5
6	6	0	6
7	7	0	7
8	8	0	8
9	9	0	9
10	a	0	a
11	b	0	b
12	c	0	c
13	d	0	d
14	e	0	e
15	f	0	f
16	10	1	0
17	11	1	1
18	12	1	2
19	13	1	3
20	14	1	4
21	15	1	5
22	16	1	6
23	17	1	7
24	18	1	8
25	19	1	9
26	1a	1	a
27	1b	1	b
28	1c	1	c

Address		Settings	
DECIMAL	HEX	Switch 2	Switch 1
29	1d	1	d
30	1e	1	e
31	1f	1	f
32	20	2	0
33	21	2	1
34	22	2	2
35	23	2	3
36	24	2	4
37	25	2	5
38	26	2	6
39	27	2	7
40	28	2	8
41	29	2	9
42	2a	2	a
43	2b	2	b
44	2c	2	c
45	2d	2	d
46	2e	2	e
47	2f	2	f
48	30	3	0
49	31	3	1
50	32	3	2
51	33	3	3
52	34	3	4
53	35	3	5
54	36	3	6
55	37	3	7
56	38	3	8
57	39	3	9

Address		Settings	
DECIMAL	HEX	Switch 2	Switch 1
58	3a	3	a
59	3b	3	b
60	3c	3	c
61	3d	3	d
62	3e	3	e
63	3f	3	f
64	40	4	0
65	41	4	1
66	42	4	2
67	43	4	3
68	44	4	4
69	45	4	5
70	46	4	6
71	47	4	7
72	48	4	8
73	49	4	9
74	4a	4	a
75	4b	4	b
76	4c	4	c
77	4d	4	d
78	4e	4	e
79	4f	4	f
80	50	5	0
81	51	5	1
82	52	5	2
83	53	5	3
84	54	5	4
85	55	5	5
86	56	5	6
87	57	5	7
88	58	5	8
89	59	5	9
90	5a	5	a
91	5b	5	b
92	5c	5	c

Address		Settings	
DECIMAL	HEX	Switch 2	Switch 1
93	5d	5	d
94	5e	5	e
95	5f	5	f
96	60	6	0
97	61	6	1
98	62	6	2
99	63	6	3
100	64	6	4
101	65	6	5
102	66	6	6
103	67	6	7
104	68	6	8
105	69	6	9
106	6a	6	a
107	6b	6	b
108	6c	6	c
109	6d	6	d
110	6e	6	e
111	6f	6	f
112	70	7	0
113	71	7	1
114	72	7	2
115	73	7	3
116	74	7	4
117	75	7	5
118	76	7	6
119	77	7	7
120	78	7	8
121	79	7	9
122	7a	7	a
123	7b	7	b
124	7c	7	c
125	7d	7	d
126	7e	7	e
127	7f	7	f

Tab.: 1 Fieldbus address via rotary switches Switch 1/Switch 2



IMPORTANT INFORMATION

The addresses marked in grey (0, 1, 126, 127) may not be used for addressing the FKO.

3.4 Installing the FKO GSD file

A "device-specific information file" is required to use the FKO drive controller with PROFIBUS.

Download the "PROFIBUS fieldbus for FKO" ZIP file from the download area on our website under the following link:

www.brinkmannpumps.de/Support/Downloads/Frequenzumrichter

Embed the GSD file as required by the PROFIBUS master you are using.

4. Accessing data via PROFIBUS

Data can be accessed via PROFIBUS both cyclically and non-cyclically (see chapter 4.3).

Cyclic data is known as a process image. It is made up of data sent by the PROFIBUS master to the drive controller and from the drive controller to the PROFIBUS master.

The cyclic data sent from the PROFIBUS master to the drive controller is known as "Process data In".

The cyclic data sent from the drive controller to the PROFIBUS master is known as "Process data Out".

4.1 Cyclic data access – Process data Out

4.1.1 Structure of Process data Out

The process data named below is sent from the drive controller to the PROFIBUS master. The data is made up of 10 process variables.



IMPORTANT INFORMATION

Thanks to a corresponding selection, the FKO also makes it possible for you to work with a process image of only 2 process variables. To this purpose, the master from the GSD file must select the "FKO I/O small" module. Both process variables involve the status word and the actual frequency.

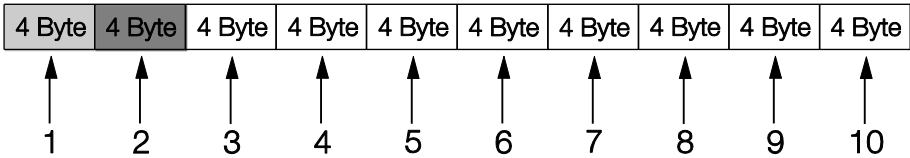

The first two process variables (status word and actual frequency) cannot be parameterised and are always sent. The remaining 8 process variables can be configured using parameters [6.080](#) to [6.087](#).

The "Process data Out" available can be found in chapter [4.1.3](#) "Process data Out". Use FKOpC, MMI or PROFIBUS master for parameterisation.

The structure of the "Process data Out" set in the factory is shown in the following table.



IMPORTANT INFORMATION

Changes to the "device-specific information file (GSD file)" may cause communication problems.

Frame No.	Address	Data type	Designation	Unit	Description
1	0x0000	WORD*	Status word	-	cannot be parameterised
2	0x0004	REAL***	Actual frequency	Hz	cannot be parameterised
3	0x0008	REAL	Process data Out 3 (Motor voltage)	V	can be parameterised using FKOpC tool (parameter 6.080)
4	0x000C	REAL	Process data Out 4 (Motor current)	A	can be parameterised using FKOpC tool (parameter 6.081)
5	0x0010	REAL	Process data Out 5 (Grid voltage)	V	can be parameterised using FKOpC tool (parameter 6.082)
6	0x0014	REAL	Process data Out 6 (Target frequency value)	Hz	can be parameterised using FKOpC tool (parameter 6.083)
7	0x0018	DWORD**	Process data Out 7 (Digital inputs with bit coding)	-	can be parameterised using FKOpC tool (parameter 6.084)

Frame No.	Address	Data type	Designation	Unit	Description
8	0x001C	REAL	Process data Out 8 (Analogue input 1)	V	can be parameterised using FKOpC tool (parameter 6.085)
9	0x0020	DWORD*	Process data Out 9 (Error word 1)	-	can be parameterised using FKOpC tool (parameter 6.086)
10	0x0024	DWORD*	Process data Out 10 (Error word 2)	-	can be parameterised using FKOpC tool (parameter 6.087)

Tab.: 2 Default structure for "Process data Out"

- * WORD data type corresponds to UINT16 = 2 bytes
- ** DWORD data type corresponds to UINT32 = 4 bytes
- *** REAL data type corresponds to = 4 bytes



INFORMATION

The 32-bit data (error status, DigOuts, DigIns) has been broken down into 16-bit data because the data width of the fieldbuses is limited to 16-bit in some places.
If 32-bit data access is possible, the 32-bit word is used regardless of whether the low or high word is being accessed!



IMPORTANT INFORMATION

The REAL depiction is the standard IEEE format
(Help: 50 % target value = 0X42480000)
The endianness of the fieldbus should be observed for all data types.

4.1.2 Structure of FKO status word

The meanings of the individual bits of the FKO status word are described in the following table.

Bit	Value	Meaning	Description
0	1	Ready for engagement	Grid voltage present, no fault
	0	Not ready for engagement	
1	1	Ready for operation	No fault / HW enable set
	0	Not ready for operation	
2	1	Operation	Motor is energised
	0	Operation blocked	
3	1	Error active	A fault is present
	0	Free from faults	
4	1	No OFF 2	On 2 off / STW bit 1 set ³ (logic can be inverted with parameter 6.066.)
	0	Electr. stop active (OFF 2)	
5	1	No OFF 3	On 3 off / STW bit 2 set ³ (logic can be inverted with parameter 6.066)
	0	Rapid stop active (OFF 3)	
6	1	Engagement inhibit active	¹ PWM blocked
	0	No engagement inhibit	¹ PWM enabled
7	1	Warning active	² A warning is present
	0	No warning	
8	1	Nominal/actual value deviation in tolerance range	Actual value within a tolerance band Parameter 6.070 / 6.071
	0	Nominal/actual value deviation outside tolerance range	
9	1	Control from AG	FKO is parameterised for activation via fieldbus
	0	No control from AG	
10	1	Target frequency reached	Actual frequency > = reference value (Parameter 6.072)
	0	Target frequency fallen below	Actual frequency < reference value

Bit	Value	Meaning	Description
11	1	Device-specific	Meaning not specified
	0	-	
12	1	Device-specific	Meaning not specified
	0	-	
13	1	Device-specific	Meaning not specified
	0	-	
14	1	Device-specific	Meaning not specified
	0	-	
15	1	Motor current limit	Motor current is limited
	0		

Tab.: 3 FKO status word

AG: Automation device

1 Deviation from standard

2 As of software version 03.61

3 As of software version 03.74

4.1.3 Process data Out which can be parameterised

The remaining 8 process variables can be selected using the FKOpC tool, MMI or PROFIBUS master by configuring parameters [6.080](#) to [6.087](#).

The process data available can be found in the following table.

Consec. no.	Data type	Availab. in SW version	Designation	Unit	Description
0	REAL		Actual frequency	Hz	
1	REAL		Output voltage	V	Motor voltage
2	REAL		Motor current	A	
3	REAL		IGBT temperature	° C	
4	REAL		Intermediate circuit voltage	V	
5	REAL		Target frequency value	Hz	

Consec. no.	Data type	Availab. in SW version	Designation	Unit	Description
6	REAL		Grid voltage	V	Input voltage
7	REAL		Intermediate circuit current	A	
8	REAL		Inner temperature	° C	FC inner temperature
9	REAL		Incremental encoder speed	Hz	only with encoder option
10	t.b.d.		Incremental encoder position		only with encoder option
11	DWORD*		Application error	1	Bit-coded
13	DWORD		Power error	1	Bit-coded
15	DWORD		Digital inputs (1..4 + output stage release)	1	Bit-coded
16	REAL		Analogue In 1	V	Analogue input 1 application
17	REAL		Analogue In 2	V	Analogue input 2 application
18	REAL		F_target ramp	Hz	Frequency target value behind ramp
19	REAL		F_target	Hz	Frequency target value of target value source
20	REAL		PID actual value	%	Actual value of PID process controller
21	REAL		PID target value	%	Target value of PID process controller
22	REAL		Analogue Out 1	V	Analogue Out 1
23	REAL		Intermediate circuit power	W	Intermediate circuit power
24	REAL		Reserved	-	Reserved
25	REAL		Reserved	-	Reserved
26	REAL		Reserved	-	Reserved
27	REAL		Reserved	-	Reserved
28	REAL		Reserved	-	Reserved
29	DWORD		BUS/Soft PLC status word	1	BUS/Soft PLC status word
30	REAL	03.02	Rotation speed	rpm	Motor shaft speed
31	REAL	03.02	Torque	Nm	Torque
32	REAL	03.02	Electric motor rating	W	Electric motor rating
33	DWORD	03.04	Virtual DigOuts (lowWord)	1	Virtual DigOuts of the soft PLC
35	REAL	03.04	Customer-specific output variable 1	1	Customer-specific soft PLC output variable
36	REAL	03.04	Customer-specific output variable 2	1	Customer-specific soft PLC output variable

Consec. no.	Data type	Availab. in SW version.	Designation	Unit	Description
37	REAL	03.04	Customer-specific output variable 3	1	Customer-specific soft PLC output variable
38	DWORD	03.05	Operating time in seconds	1	Operating time in seconds
39	DWORD	03.05	Power On cycles	1	Power On cycles
40	REAL	03.05	Electric energy Wh	Wh	Total electric energy
41	DWORD	03.05	Status of outputs (DigOut 1 + 2, relays 1 + 2)		Status of outputs
42	DWORD*		Application error (at present)	1	Bit-coded
44	DWORD		Application error (at present)	1	Bit-coded

Tab.: 4 Process data Out which can be parameterised

*Data type DWORD corresponds to UINT32

4.2 Cyclic data access – Process data In

The process data listed below is sent from the PROFIBUS master to the drive controller. The data is made up of 6 process variables.



IMPORTANT INFORMATION

Thanks to a corresponding selection, the FKO also makes it possible for you to work with a process image of only 2 process variables. To this purpose, the master from the GSD file must select the "FKO I/O small" module. Both process variables involve the control word and the rated rotational speed.

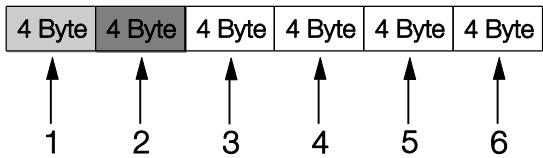

The first two process variables (control word and target value) cannot be parameterised and are always expected. The remaining 4 process variables can be configured using parameters 6.110 to 6.113.

The "Process data In" available can be found in chapter [4.2.2 "Process data In"](#). Use FKOpC, MMI or PROFIBUS master for parameterisation.

The structure of the "Process data In" set in the factory is shown in the following table.

Frame no.	Address	Data type	Designation	Unit	Description
1	0x0000	WORD*	Control word (see 4.2.1)		cannot be parameterised
2	0x0004	REAL***	Target value	%	cannot be parameterised
3	0x0008	DWORD**	Process data In 3 (Digital output 1 – relay)		can be parameterised using FKOpC tool (parameter 6.110)
4	0x000C	REAL	Process data In 4 (Analogue output 1)	V	can be parameterised using FKOpC tool (parameter 6.111)
5	0x0010		Process data In 5 (Reserved)		can be parameterised using FKOpC tool (parameter 6.112)
6	0x0014		Process data In 6 (Reserved)		can be parameterised using FKOpC tool (parameter 6.113)

Tab.: 5 Process data In

- * WORD data type corresponds to UINT16 = 2 bytes
- ** DWORD data type corresponds to UINT32 = 4 bytes
- *** REAL data type corresponds to = 4 bytes

4.2.1 Structure of FKO control word

The meanings of the individual bits of the FKO control word are described in the following table.



IMPORTANT INFORMATION

The control word is only accepted if bit 10 (control from AG) is set, otherwise the sent control word is rejected.



IMPORTANT INFORMATION

The target value is only accepted if bit 6 (target value enabled) is set. Otherwise the target value is rejected.

Bit	Value	Meaning	Description
0	1*	ON 1	Engagement condition 1
	0	OFF 1	Shut down via ramp
1	1*	ON 2	Engagement condition 2
	0	Electr. stop (OFF 2)	Switch off PWM, free shutdown
2	1*	ON 3	Engagement condition 3
	0	Rapid stop (OFF 3)	Shut down via fastest possible ramp
3	1*	Operating condition 1	Operating condition 1
	0		Switch off PWM, free shutdown
4	1*	Operating condition 2	Operating condition 2
	0		Shut down via fastest possible ramp
5	1	Block HLG	¹ Not implemented
	0	Stop HLG	¹ Not implemented
6	1*	Enable target value	Adopt target value
	0	Block target value	Reject target value
7	1	Error acknowledgement (0->1)	Collective acknowledgement on pos. flank
	0*	---	---

Bit	Value	Meaning	Description
8	1	JOG (right)	¹ Not implemented
	0		¹ Not implemented
9	1	JOG (left)	¹ Not implemented
	0		¹ Not implemented
10	1*	Control from AG	Management via interface, control word valid
	0		Control word is rejected
11	1	Device-specific	-
	0		
12	1	Device-specific	-
	0		
13	1	Device-specific	-
	0		
14	1	Device-specific	-
	0		
15	1	Device-specific	-
	0		

Tab.: 6 Control word

HLG: Ramp function generator

* Operating condition

¹ Deviation from standard



IMPORTANT INFORMATION

An example of a control word with which the start-up works is 0x45F.

The endianness of the fieldbus should be observed for all data types.

4.2.2 Process data In which can be parameterised

The remaining 4 process variables (2 – 6) can be parameterised with the help of the FKOpC tool using parameters 6.110 to 6.113. The available process variables of the parameter settings can be found in the following table.

Consec. no.	Data type	SW vers.	Designation	Unit	Description
0	DWORD*	03.02	Digital relay outputs	1	Control of digital and relay outputs
1	REAL	03.02	Analogue Out 1	V	Control of analogue output
2	DWORD	03.04	Customised input variable 1	1	Customised input variable Soft PLC (32 bit)
4	REAL	03.04	Customised Input variable 2 / PID actual value	-	Customised input variable Soft PLC
5	REAL	03.04	Customised input variable 3	-	Customised input variable Soft PLC
6	REAL	03.04	Customised input variable 4	-	Customised input variable Soft PLC

Tab.: 7 Process data In which can be parameterised

* DWORD data type corresponds to UINT32 = 4 bytes

4.3 Non-cyclic data access / parameters



IMPORTANT INFORMATION

Only parameters with an access level of 2 or less can be accessed (see list of parameters in operating manual).
Access for both reading and writing is possible.



IMPORTANT INFORMATION

You will find detailed information about the parameters in the "Parameters" chapter of the "FKO drive controller" operating manual.

4.3.1 Non-cyclic data

PROFIBUS principally has a slot and an address when accessing non-cyclical data. Both are 8 bit values.

The index covers the number range from 0 – 255.

The slot supports the values 0, 1 and 2.

The addressing of the non-cyclical data can be carried out in 2 different ways.

4.3.2 Direct access

Slots 1 and 2 are used for direct access.

The number of the parameter to be read or written is composed of the slot number and the transmitted index of the non-cyclical access.

Slot no. 1 addresses the parameters 0 – 255 through the index.

Slot no. 2 addresses the parameters 256 – 511 through the index.



INFORMATION

The Siemens S7 PROFIBUS master offers the functional components SFB 52 and SFB 53 for direct access.

The slot number is addressed by the parameter ID of the SFBs.

The INDEX is addressed by the parameter INDEX of the SFBs.

Slot	Index	Parameter
1	0	0
1	1	1
1	•	•
1	•	•
1	254	254
1	255	255

Slot	Index	Parameter
2	0	256
2	1	257
2	•	•
2	•	•
2	254	510
2	255	511

4.3.3 Indirect access

The slot "0" and index "0" and "1" are used for indirect access.

The reading and writing of the non-cyclical data is carried out here in 2 steps.

The following depiction should be helpful to you in implementing the two steps.

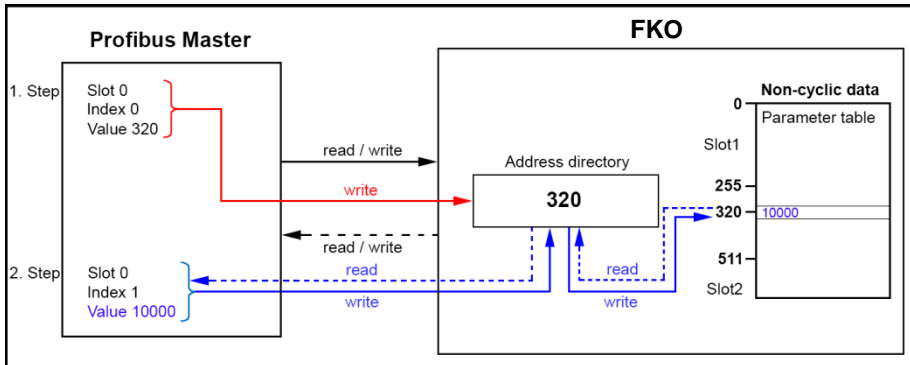

In the first step, a value 0 - 511* must be written into the address directory of the FKO by the PROFIBUS master via slot "0", index "0".

In the example presented above, the value "320" was written into the address directory.

In the second step, the PROFIBUS master (reading/writing) accesses through slot "0", index "1", the value addressed by the address directory.



IMPORTANT INFORMATION

Prior to accessing slot "0" and index "1", the correct description of the address directory is absolutely necessary.

The transfer will otherwise be cancelled with an error message.

In the example presented above, the PROFIBUS master reads and writes the value "10000" into the parameter "320" of the parameter table.

* Maximum number of parameters for FKO

4.3.4 Parameter

The following parameters can be accessed non-cyclically for reading and writing.



IMPORTANT INFORMATION

Changing a parameter value via the fieldbus includes direct EEPROM write access.



INFORMATION

The data below is listed sorted in ascending order by "Number*".

PROFIBUS		FKO parameter						
Slot	Index	Parameter	Number*	Accepted	Name in German	Minimum	Maximum	Unit
1	0	0	1,020	2: Always	Minimum frequency	0	400	Hz
1	1	1	1,021	2: Always	Maximum frequency	5	400	Hz
1	3	3	1,050	2: Always	Deceleration time 1	0.1	1000	s
1	4	4	1,051	2: Always	Run up time 1	0.1	1000	s
1	48	48	1,052	2: Always	Deceleration time 2	0.1	1000	s
1	49	49	1,053	2: Always	Run up time 2	0.1	1000	s
1	50	50	1,054	2: Always	Ramp selection	0	9	
1	172	172	1,088	2: Always	Deceleration time 3	0.1	1000	s
1	8	8	1,100	2: Always	Operating mode	0	3	
1	5	5	1,130	2: Always	Target value source	0	10	
1	7	7	1,131	2: Always	Target value approval	0	16	
1	81	81	1,132	2: Always	Start protection	0	8	
1	41	41	1,150	2: Always	Rotation direction	0	16	
1	53	53	1,180	2: Always	Acknowledge function	0	7	

Accessing data via PROFIBUS

PROFIBUS		FKO parameter						
Slot	Index	Parameter	Number*	Accepted	Name in German	Minimum	Maximum	Unit
1	54	54	1,181	2: Always	Auto acknowledgement	0	1000	s
1	109	109	1,182	2: Always	Auto ackn. no.	0	500	
1	55	55	2,050	2: Always	Fixed frequency mode	0	4	
1	9	9	2,051	2: Always	Fixed frequency 1	-400	400	Hz
1	10	10	2,052	2: Always	Fixed frequency 2	-400	400	Hz
1	11	11	2,053	2: Always	Fixed frequency 3	-400	400	Hz
1	12	12	2,054	2: Always	Fixed frequency 4	-400	400	Hz
1	13	13	2,055	2: Always	Fixed frequency 5	-400	400	Hz
1	14	14	2,056	2: Always	Fixed frequency 6	-400	400	Hz
1	15	15	2,057	2: Always	Fixed frequency 7	-400	400	Hz
1	139	139	2,150	2: Always	MOP digit. input	0	8	
1	51	51	2,151	2: Always	MOP step range	0	100	%
1	141	141	2,152	2: Always	MOP step time	0.02	1000	s
1	140	140	2,153	2: Always	MOP react. Time	0.02	1000	s
1	142	142	2,154	2: Always	MOP reference memory	0	1	
1	37	37	3,050	2: Always	PID-P amplif.	0	100	
1	38	38	3,051	2: Always	PID-I amplif.	0	100	1/s
1	39	39	3,052	2: Always	PID-D amplif.	0	100	s
1	6	6	3,060	2: Always	PID actual value	0	3	
1	82	82	3,061	2: Always	PID inverted	0	1	
1	83	83	3,062	2: Always	PID fixed nominal value 1	0	100	%
1	127	127	3,063	2: Always	PID fixed nominal value 2	0	100	%
1	128	128	3,064	2: Always	PID fixed nominal value 3	0	100	%

PROFIBUS		FKO parameter						
Slot	Index	Parameter	Number*	Accepted	Name in German	Minimum	Maximum	Unit
1	129	129	3,065	2: Always	PID fixed nominal value 4	0	100	%
1	130	130	3,066	2: Always	PID fixed nominal value 5	0	100	%
1	131	131	3,067	2: Always	PID fixed nominal value 6	0	100	%
1	132	132	3,068	2: Always	PID fixed nominal value 7	0	100	%
1	133	133	3,069	2: Always	PID fixed nominal mod	0	2	
1	84	84	3,070	2: Always	PID standby time	0	1000	s
1	85	85	3,071	2: Always	PID standby hyst.	0	50	%
1	166	166	3,072	2: Always	PID dry. Time	0	32767	s
1	169	169	3,073	2: Always	PID target value min	0	100	%
1	170	170	3,074	2: Always	PID target value max	0	100	%
1	25	25	4,020	2: Always	AI1 input type	1	2	
1	26	26	4,021	2: Always	AI1 standard. Low	0	100	%
1	27	27	4,022	2: Always	AI1 standard. High	0	100	%
1	23	23	4,023	2: Always	AI1 dead time	0	100	%
1	22	22	4,024	2: Always	AI1 filter time	0.02	1	s
1	19	19	4,030	2: Always	AI1 function	0	1	
1	103	103	4,033	2: Always	AI1-phys unit	0	10	
1	104	104	4,034	2: Always	AI1 phys min	-10000	10000	%
1	105	105	4,035	2: Always	AI1 phys max	-10000	10000	%
1	167	167	4,036	2: Always	AI1 wire break time	0	32767	s
1	34	34	4,050	2: Always	AI2 input type	1	2	
1	35	35	4,051	2: Always	AI2 standard Low	0	100	%
1	36	36	4,052	2: Always	AI2 standard High	0	100	%
1	32	32	4,053	2: Always	AI2 dead time	0	100	%

Accessing data via PROFIBUS

PROFIBUS		FKO parameter						
Slot	Index	Parameter	Number*	Accepted	Name in German	Minimum	Maximum	Unit
1	31	31	4,054	2: Always	AI2 filter time	0.02	1	s
1	28	28	4,060	2: Always	AI2 function	0	1	
1	106	106	4,063	2: Always	AI2-phys unit	0	10	
1	107	107	4,064	2: Always	AI2 phys min	-10000	10000	%
1	108	108	4,065	2: Always	AI2 phys max	-10000	10000	%
1	168	168	4,066	2: Always	AI2 wire break time	0	32767	s
1	42	42	4,100	2: Always	AO1 function	0	40	
1	43	43	4,101	2: Always	AO1 standard Low	-32767	32767	
1	80	80	4,102	2: Always	AO1 standard high	-32767	32767	
1	120	120	4,110	2: Always	DI1 inverted	0	1	
1	121	121	4,111	2: Always	DI2 inverted	0	1	
1	122	122	4,112	2: Always	DI3 inverted	0	1	
1	123	123	4,113	2: Always	DI4 inverted	0	1	
1	56	56	4,150	2: Always	DO1 function	0	60	
1	57	57	4,151	2: Always	DO1 on	-32767	32767	
1	58	58	4,152	2: Always	DO1 off	-32767	32767	
1	59	59	4,170	2: Always	DO2 function	0	60	
1	60	60	4,171	2: Always	DO2 on	-32767	32767	
1	61	61	4,172	2: Always	DO2 off	-32767	32767	
1	62	62	4,190	2: Always	Rel.1 function	0	60	
1	63	63	4,191	2: Always	Relay 1 on	-32767	32767	
1	64	64	4,192	2: Always	Relay 1 off	-32767	32767	
1	94	94	4,193	2: Always	Relay 1 on delay	0	10000	s

PROFIBUS		FKO parameter						
Slot	Index	Parameter	Number*	Accepted	Name in German	Minimum	Maximum	Unit
1	95	95	4,194	2: Always	Relay 1 off delay	0	10000	s
1	65	65	4,210	2: Always	Relay 2 function	0	60	
1	66	66	4,211	2: Always	Relay 2 on	-32767	32767	
1	67	67	4,212	2: Always	Relay 2 off	-32767	32767	
1	96	96	4,213	2: Always	Relay 2 on delay	0	10000	s
1	97	97	4,214	2: Always	Relay 2 off delay	0	10000	s
1	160	160	4,230	2: Always	VO function	0	60	
1	161	161	4,231	2: Always	VO on	-10000	10000	
1	162	162	4,232	2: Always	VO off	-10000	10000	
1	163	163	4,233	2: Always	VO on delay	0	32767	s
1	164	164	4,234	2: Always	VO off delay	0	32767	s
1	124	124	5,010	2: Always	External fault 1	0	7	
1	125	125	5,011	2: Always	External fault 2	0	7	
1	86	86	5,070	2: Always	Motor current limit %	0	250	%
1	87	87	5,071	2: Always	Motor current limit s	0	100	s
1	156	156	5,075	2: Always	Gearbox factor	0	1000	
1	111	111	5,080	2: Always	Blocking detection	0	1	
1	154	154	5,081	2: Always	Block.time	1	50	s
1	171	171	5,082	2: Always	Start-up error_current	0	1	
1	138	138	5,090	2: Always	Par.set change	0	12	
1	70	70	5,100	2: Always	Techn.param.1	-9999999	9999999	
1	71	71	5,101	2: Always	Techn.param.2	-9999999	9999999	
1	72	72	5,102	2: Always	Techn.param.3	-9999999	9999999	

Accessing data via PROFIBUS

PROFIBUS		FKO parameter						
Slot	Index	Parameter	Number*	Accepted	Name in German	Minimum	Maximum	Unit
1	73	73	5,103	2: Always	Techn.param.4	-9999999	9999999	
1	74	74	5,104	2: Always	Techn.param.5	-9999999	9999999	
1	75	75	5,105	2: Always	Techn.param.6	-9999999	9999999	
1	76	76	5,106	2: Always	Techn.param.7	-9999999	9999999	
1	77	77	5,107	2: Always	Techn.param.8	-9999999	9999999	
1	78	78	5,108	2: Always	Techn.param.9	-9999999	9999999	
1	79	79	5,109	2: Always	Techn.param.10	-9999999	9999999	
1	144	144	5,110	2: Always	Techn.param.11	-32768	32767	
1	145	145	5,111	2: Always	Techn.param.12	-32768	32767	
1	146	146	5,112	2: Always	Techn.param.13	-32768	32767	
1	147	147	5,113	2: Always	Techn.param.14	-32768	32767	
1	148	148	5,114	2: Always	Techn.param.15	-32768	32767	
1	149	149	5,115	2: Always	Techn.param.16	-32768	32767	
1	150	150	5,116	2: Always	Techn.param.17	-32768	32767	
1	151	151	5,117	2: Always	Techn.param.18	-32768	32767	
1	152	152	5,118	2: Always	Techn.param.19	-32768	32767	
1	153	153	5,119	2: Always	Techn.param.20	-32768	32767	
1	98	98	6,050	2: Always	SAS/ SPF adr	0	31	
1	110	110	6,051	2: Always	SAS baud rate	0	3	
1	99	99	6,060	0: Commissioning	Fieldbus address	0	127	
1	100	100	6,061	0: Commissioning	Fieldbus baud rate	0	8	
1	102	102	6,062	2: Always	Bus time-out	0	100	s
1	176	176	6,066	2: Always	Status word Bits 4/5	0	1	

Accessing data via PROFIBUS

PROFIBUS		FKO parameter						
Slot	Index	Parameter	Number*	Accepted	Name in German	Minimum	Maximum	Unit
1	157	157	6,070	2: Always	Target/actual value dev.	0	100	%
1	158	158	6,071	2: Always	Tolerance range	0	32767	s
1	159	159	6,072	2: Always	Target comp. value	0	400	Hz
1	112	112	6,080	2: Always	Process data Out 3	0	49	
1	113	113	6,081	2: Always	Process data Out 4	0	49	
1	114	114	6,082	2: Always	Process data Out 5	0	49	
1	115	115	6,083	2: Always	Process data Out 6	0	49	
1	116	116	6,084	2: Always	Process data Out 7	0	49	
1	117	117	6,085	2: Always	Process data Out 8	0	49	
1	118	118	6,086	2: Always	Process data Out 9	0	49	
1	119	119	6,087	2: Always	Process data Out 10	0	49	
1	134	134	6,110	2: Always	Process data In 3	0	10	
1	135	135	6,111	2: Always	Process data In 4	0	10	
1	136	136	6,112	2: Always	Process data In 5	0	10	
1	137	137	6,113	2: Always	Process data In 6	0	10	
2	102	358	32,100	0: Commissioning	Output power PM	0	1100	W
2	112	368	33,001	1: Ready	Type of motor	1	2	
2	100	356	33,010	2: Always	I2T fact. motor	0	1000	%
2	84	340	33,011	2: Always	I2T time	0	1200	s
2	132	388	33,015	1: Ready	R optimisation	0	200	%
2	147	403	33,016	1: Ready	Motor phase monitoring	0	1	
2	70	326	33,031	1: Ready	Motor current	0	150	A
2	71	327	33,032	1: Ready	Motor rating	50	55000	W

PROFIBUS		FKO parameter						
Slot	Index	Parameter	Number*	Accepted	Name in German	Minimum	Maximum	Unit
2	73	329	33,034	1: Ready	Motor speed	0	80000	rpm
2	74	330	33,035	1: Ready	Motor frequency	10	400	Hz
2	115	371	33,050	1: Ready	Stator resistance	0	100	Ohm
2	117	373	33,105	1: Ready	Scatter inductivity	0	1	H
2	68	324	33,110	1: Ready	Motor voltage	0	1500	V
2	72	328	33,111	1: Ready	Motor cos phi	0.5	1	
2	125	381	33,138	2: Always	Holding current time	0	3600	s
2	116	372	33,200	1: Ready	Stator induc.	0	1	H
2	129	385	33,201	1: Ready	Nominal flux	0	10000	mVs
2	111	367	34,010	1: Ready	Control method	100	299	
2	85	341	34,011	1: Ready	Type of encoder	0	2	1
2	86	342	34,012	1: Ready	Encoder line count	0	10000	1
2	87	343	34,013	2: Always	Encoder offset	-360	360	°
2	131	387	34,020	2: Always	Flying restart	0	1	
2	130	386	34,021	2: Always	Catch time	0	10000	ms
2	8	264	34,030	2: Always	Switching frequency	1	4	
2	121	377	34,090	2: Always	Speed controller Kp	1	10000	mA/rad/s
2	122	378	34,091	2: Always	Speed controller Tn	0	10	s
2	113	369	34,110	2: Always	Slip trimmer	0	1.5	
2	138	394	34,120	2: Always	Quadr. characteristic curve	0	1	
2	139	395	34,121	2: Always	Flux adjustment	10	100	%
2	114	370	34,130	2: Always	Control reserve voltage	0	3	
2	137	393	34,225	1: Ready	Field weaken.PMSM	0	1	

Accessing data via PROFIBUS

PROFIBUS		FKO parameter						
Slot	Index	Parameter	Number*	Accepted	Name in German	Minimum	Maximum	Unit
2	136	392	34,226	2: Always	PMSM start-up current	5	1000	%
2	143	399	34,227	1: Ready	PMSM init. time	0	100	s
2	140	396	34,228	1: Ready	PMSM start-up procedure	0	1	
2	141	397	34,229	1: Ready	PMSM start-up ramp	0.1	1000	s
2	142	398	34,230	1: Ready	Start-up frequency P	5	400	Hz
2	120	376	35,080	2: Always	Brake chopper	0	1	

Tab.: 8 Parameter

5. Error detection and troubleshooting

The errors from the application and power side can be issued in the Process data Out (see Chapter 4.1.3 "Process data Out which can be parameterised" / serial no. 11, 13).

5.1 Error word of application side

The following section contains a list of possible error messages of the application.

Bit.	Error number	Description
0	1	Undervoltage 24 V application
1	2	Overvoltage 24 V application
5	6	Customer PLC version error
7	8	Communication application<>power
9	10	Parameter distributor
10	11	Power time out
12	13	Cable break at analogue in 1 (4–20 mA / 2–10 V)
13	14	Cable break at analogue in 2 (4–20 mA / 2–10 V)
14	15	Stall detection
15	16	PID dry run
16	17	Start-up error
17	18	Excess temperature for frequency converter application
20	21	Bus time-out
21	22	Acknowledgement error

Bit.	Error number	Description
22	23	External fault 1
23	24	External fault 2
24	25	Motor detection
25	26	STO inputs plausibility

Tab.: 9 Application error word

5.2 Error word of power side

The following section contains a list of possible power side error messages.

Bit.	Error number	Description
0	32	Trip IGBT
1	33	Overvoltage of intermediate circuit
2	34	Undervoltage of intermediate circuit
3	35	Excess motor temperature
4	36	Power failure
6	38	Excess IGBT module temperature
7	39	Overcurrent
8	40	Excess frequency converter temperature
10	42	I ² T motor protection shut-off
11	43	Ground leak
13	45	Motor connection disrupted
14	46	Motor parameters
15	47	Drive controller parameters
16	48	Type plate data
17	49	Power class restriction
21	53	Motor tipped

Tab.: 10 Power error word

6. EC declaration of conformity

DEUTSCH / ENGLISH / FRANÇAIS / ESPAÑOL



EG-Konformitätserklärung

EC declaration of conformity / Déclaration de conformité CE / Declaración de conformidad CE

Hersteller / Manufacturer / Constructeur / Fabricante

Brinkmann Pumpen, K. H. Brinkmann GmbH & Co. KG
Friedrichstraße 2, D-58791 Werdohl

Produktbezeichnung / Product name / Désignation du produit / Designación del producto

Antriebsregler / Drive control / Convertisseur de fréquence / Regulador de accionamiento

Typ / Type / Tipo **FKO / FKO PROFIBUS**

Das bezeichnete Produkt stimmt mit den folgenden Richtlinien des Rates zur Angleichung der Rechtsvorschriften der EG-Mitgliedsstaaten überein:

The named product conforms to the following Council Directives on approximation of laws of the EEC Member States:

Le produit sus-mentionné est conforme aux Directives du Conseil concernant le rapprochement des législations des Etats membres CEE:

El producto designado cumple con las Directivas del Consejo relativas a la aproximación de las legislaciones de los Estados Miembros de la CEE:

2006/95/EG Niederspannungsrichtlinie

2006/95/EC low voltage guide lines

2006/95/CEE Directive "Basse Tension"

2006/95/CEE Directivas de bajo voltaje

2004/108/EG Richtlinie für elektromagnetische Verträglichkeit

2004/108/EC Council Directive for Electromagnetic compatibility

2004/108/CEE Directive du Conseil pour Compatibilité électromagnétique

2004/108/CEE Directivas del Consejo para Compatibilidad electromagnética

Die Übereinstimmung mit den Vorschriften dieser Richtlinien wird nachgewiesen durch die vollständige Einhaltung folgender Normen:

Conformity with the requirements of this Directives is testified by complete adherence to the following standards:

La conformité aux prescriptions de ces Directives est démontrée par la conformité intégrale avec les normes suivantes:

La conformidad con las prescripciones de estas directivas queda justificada por haber cumplido totalmente las siguientes normas:

Harmonisierte Europ. Normen / Harmonised Europ. Standards / Normes europ. harmonisées / Normas europ. Armonizadas

EN 61800-3:2004 + A1 :2012 EN 61800-5-1 :2007

Die Hinweise in der Betriebsanleitung für den Einbau und die Inbetriebnahme des Antriebsreglers sind zu beachten.

The instructions contained in the operating manual for installation and start up the drive control have to be followed.

Les indications d'installation / montage et de mise en service du convertisseur de fréquence prévues dans l'instruction d'emploi doivent être suivies.

Tenga en cuenta las instrucciones en el manual para la instalación y puesta en marcha del regulador de accionamiento.

Brinkmann Pumpen, K. H. Brinkmann GmbH & Co. KG

Werdohl, 14.10.2015

.....
Norbert Burk| Leiter Qualitätsmanagement / Manager of quality
management / Directeur de gestion de la qualité /
Director de gestión de calidad

Dr. H. Abou Dayé

K. H. Brinkmann GmbH & Co. KG
Friedrichstraße 2, D-58791 Werdohl

Dokumentationsbevollmächtigter /
Representative of documentation /
Mandataire de documentation /
Mandatario de documentación

Notes



BRINKMANN PUMPEN
K.H. Brinkmann GmbH & Co. KG
Friedrichstraße 2
58791 Werdohl
Germany
Tel. +49 (0)2392 5006-0
Fax +49 (0)2392 5006-180
sales@brinkmannpumps.de
www.brinkmannpumps.de